

Best for 120-200 mm depth  
double sided light boxes

5 years warranty

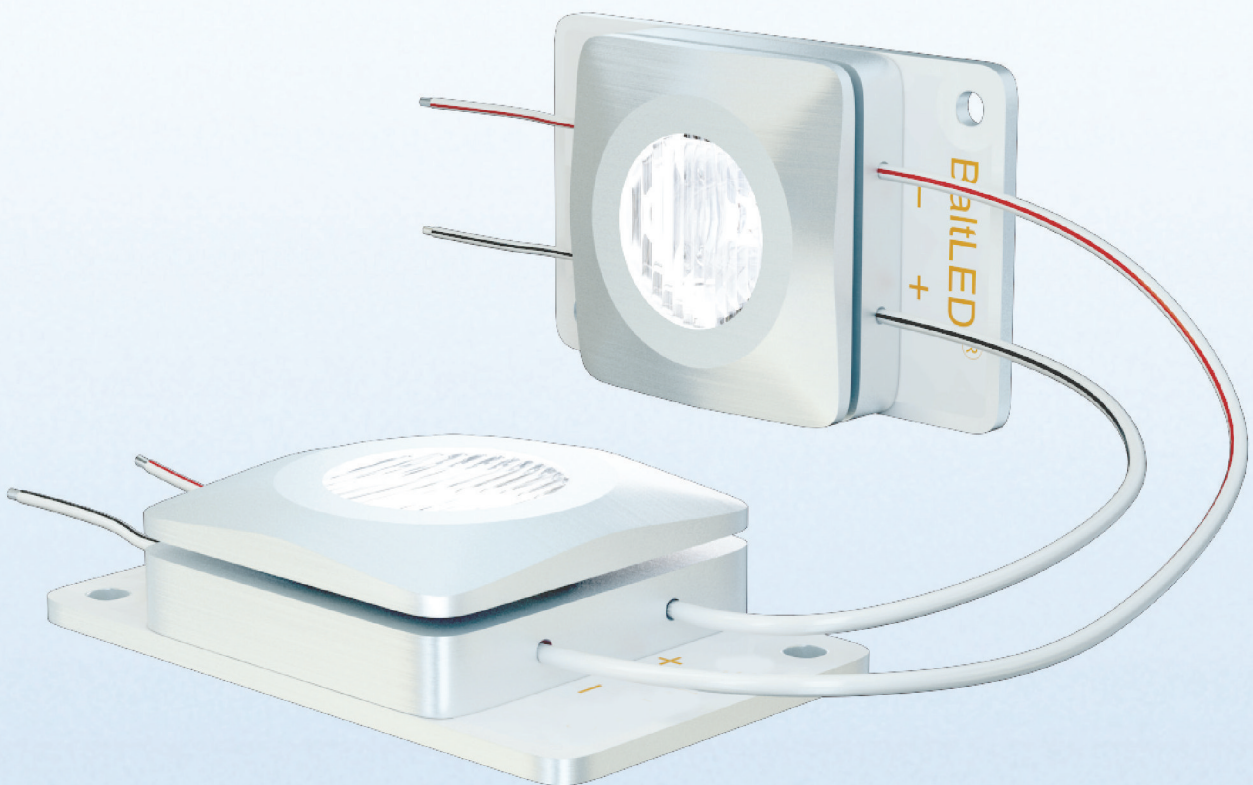

Crown DUO H32.2



**Created for:**

- Illumination of medium depth double sided light boxes
- Unique and patented design
- Significantly improved cooling

**Special Features:**

- Special elliptical lens
- IC-LED protection inside
- 350 mA constant current driving system
- 107 lumen per module; 107 lm/W
- Over 80 CRI

**Applications:**

- Double sided signs from 120-200mm
- Can be installed with 100mm step
- Designed for 5 years operation

**Other features:**

- 70% light output up to 50 000h at 50°C Ta
- 15 pcs per String, 1 pcs more than the old one
- Better efficiency
- Samsung Led with LM-80 adopted

**Module dimensions (mm)**

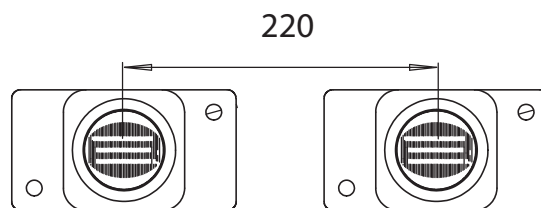
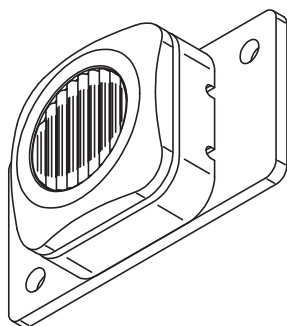
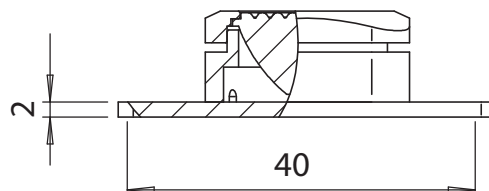
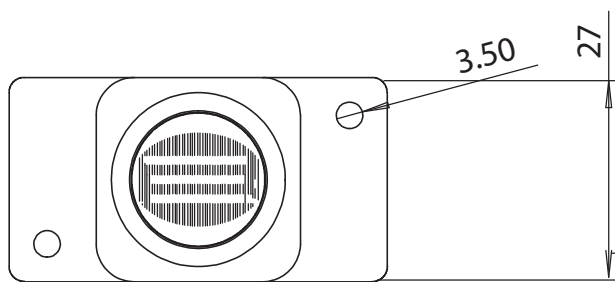

**Technical specifications table**

Input	Input	Typical luminous flux	Power	Color temperature
BMP-H32.2-O1UOELPW1	350 mA	105 - 110 lm	1W	6500 - 7000 K

! Operating temperature: from -35°C to +50°C Storage temperature: from -40°C to +90°C

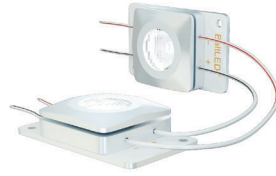

Led module light distribution graph

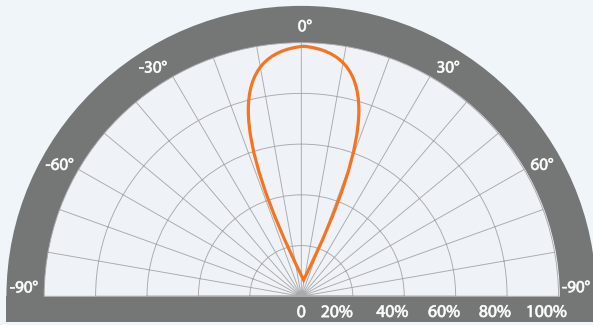

Latitudinal (vertical angle) Polar Radiation Pattern

Led module light distribution graph

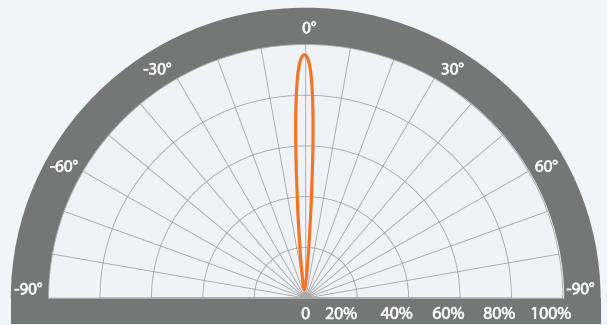

Latitudinal (vertical angle) Polar Radiation Pattern

Led module light distribution table

Relative intensity	Angle
20 %	56
50 %	38
80 %	14

Led module light distribution table

Relative intensity	Angle
20 %	20
50 %	12
80 %	6

Color temperature CIE graph

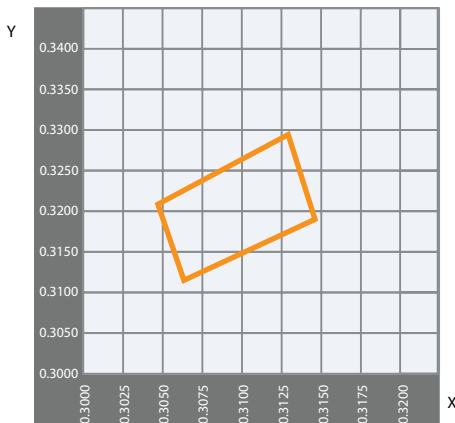

CIE graph coordinates

CIE x	CIE y
0.3068	0.3113
0.3144	0.3186
0.3130	0.3290
0.3048	0.3207

Other family products for various depths

Product Depth (mm)	120	140	160	180	200
Crown DUO R13	<input type="checkbox"/>	<input type="checkbox"/>	<input type="checkbox"/>	<input type="checkbox"/>	
Crown DUO R21			<input type="checkbox"/>	<input type="checkbox"/>	<input type="checkbox"/>
Crown DUO H32.2	<input type="checkbox"/>	<input type="checkbox"/>	<input type="checkbox"/>	<input type="checkbox"/>	<input type="checkbox"/>
Crown DUO H 41			<input type="checkbox"/>	<input type="checkbox"/>	<input type="checkbox"/>



### Attention!

Max. number of modules in one chain when the power supplied from the single end - 15 pcs

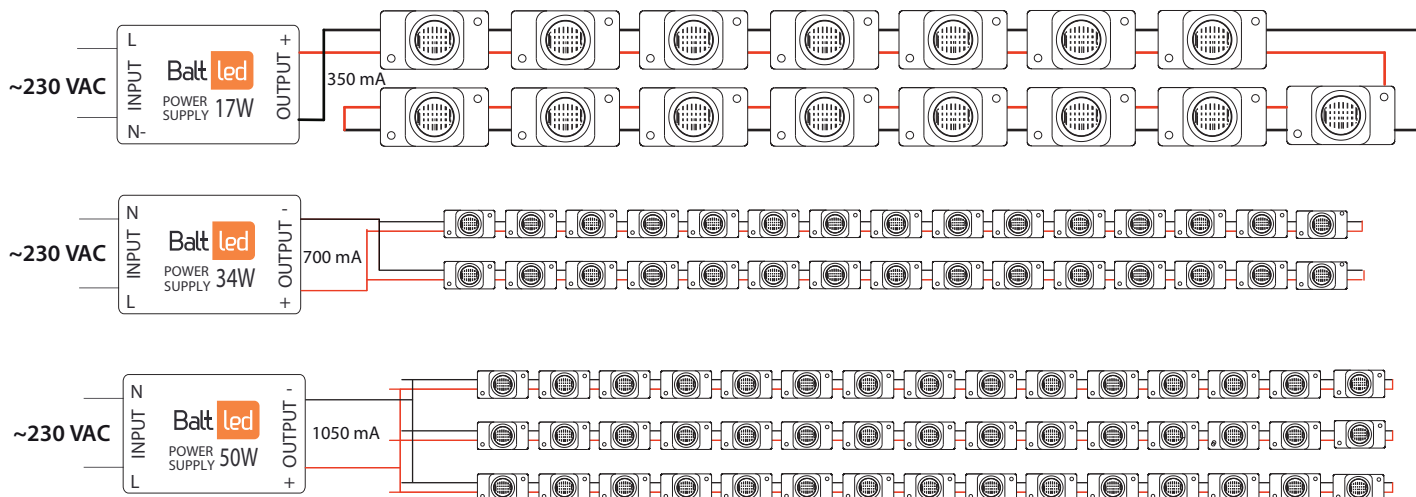

NOTE: Refer to connection scheme for installation guide. Incorrect connection may cause short circuit and product failure. Please refer to the installation guide for more information.

**!** WARNING: Make sure power supply is unplugged during LED wires connection.

### Modules per power supply

Power supply	MIN	MAX	Connection
BP-C350-170	3	15	1 string
BP-C700-340	8	30	2 strings in parallel
BP31-C700-36	22	30	2 strings in parallel
BP51-C700-35	22	30	2 strings in parallel
BP51-C700-100	58	98	2 strings in parallel

### Package Weight

Item	Quantity	Neto	Bruto
Chain	15 pcs	0,435 kg	0,43
Bag	45 pcs	1,305 kg	1,355
Box	270 pcs	7,783 kg	8,230